

Core **Toroid 107/65/18**

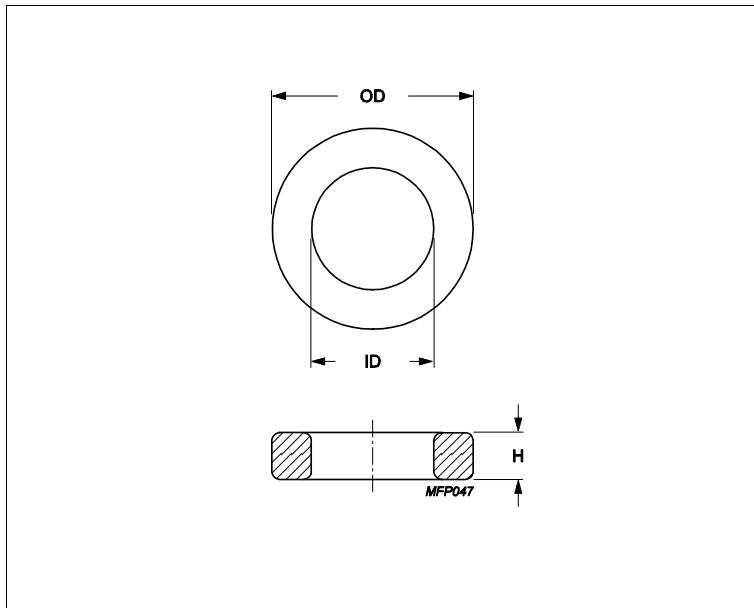

Effective parameters			
	Parameter	Value	Unit
$\Sigma(I/A)$	core factor (C1)	0.7	mm ⁻¹
Ve	effective volume	96000	mm ³
Le	effective length	259	mm
Ae	effective area	370	mm ²
m	mass of core	≈ 456	g/pcs

Epoxy coating DC isolation voltage 2000.

Maximum operating temperature of the coating is 200°C.

Dimensions (mm)

Cores	OD	ID	H	
T107/65/18	107 ± 2	65 ± 1.3	18 ± 0.35	Uncoated
TX107/65/18	109.5 max	63.3 min	18.85 max	Epoxy Coated

Core data

Cores	Material	AI (nH/turns ²)	AI tolerance	μe
T107/65/18	3C11	7720	± 25%	≈ 4300
T107/65/18	3C94	4130	± 25%	≈ 2300
T107/65/18	3E27	9870	± 25%	≈ 5500

Core data

Cores	Material	AI (nH/turns ²)	AI tolerance	μe
TX107/65/18	3C11	7720	± 25%	≈ 4300
TX107/65/18	3C94	4130	± 25%	≈ 2300
TX107/65/18	3E27	9870	± 25%	≈ 5500